

OPERATING MANUEL

Model : **DX-ECAS** CAPASITIVE LEVEL SWITCH



Information in this manual is reviewed and completely reliable. Responsibility is not assumed due to any typing error. Products in this manual are available only for information purpose and they may be changed without notice.



Models :

- DX-ECAS 101 / 102 / 103 / 107
- DX-ECAS 202 / 203 / 204 / 205 / 20S
- DX-ECAS 301 / 304 / 305 / 30D
- DX-ECAS 408A



Important Notes:

Used Symbols :



: Caution



: Note



: Disposal

- Please read this manual carefully before installation of the **capasitive level switch**. User is responsible for accidents and losses arising from failure to comply with the warnings in this manual.
- In the event that **capasitive level switch** is broken, take measures in order to prevent accidents and losses which can occur in its system.
- There is not any fuse and circuit breaker on the instrument; they should have been added to the system by the user.
- This manual should be stored in an easily accessible place for subsequent use.
- The manufacturer's liability cannot exceed the purchase price of the device according to the law.
- Do not make any modification on the instrument and do not try to repair it. Reparation should be made by authorized service staff.
- Do not operate the system before making assembly in compliance with the assembly chart related to the instrument.
- Products which do not contain label and serial number are considered to be excluded from the warranty scope.
- The instrument's useful life, determined and announced by the ministry, is 10 years.

Table of Contents :

1.	General Information	2
2.	Installation	8
3.	Failure Detection	19
4.	Disassembly of Instrument	19
5.	Service	19
6.	Recalibration	19
7.	Repair	19
8.	Disposal	19
9.	Terms of Warranty	19
10.	Terms of Return	19

1. General Information :

1.1. Material Acceptance

DX-ECAS Capacitive level switch is a capacitive level sensor for level measurement of conductive liquid, nonconductive liquid, granulated materials with solid particles, adhesive and acid/basic liquids. When a material comes between electrode rod and tank wall, a capacitance change occurs and when this change exceed adjustment threshold, contact output is delivered. Designed for difficult process conditions. Refrigerated models can be manufactured for high temperature and pressure conditions. Calibrations of triggering point and relay operation range can be performed by the user under workplace conditions. It can be connected horizontally or vertically.

1.2. Information about Areas of Use

Liquid tanks, food machines, cooling liquid tanks, shipping, glycol tanks, brine, waste water tanks.

Oil tanks, CO2 liquid tanks, high temperature tanks, non-conductive liquids.

Grain stores, cement, sand feed, flour, milk powder, organic and plastic granule.

Sticky hot and high viscosity liquid, acid and chemical liquids.

Ambient Conditions:

Relative Humidity: 0-98 %RH

Ambient temperature: 60C (It is not used under -20 C)

Advantages:

- * Optionally high temperature-resistant design.
- * Easy assembly and sensitivity adjustment.
- * No need to clean.
- * Not affected by foam, liquid splash and probe coating.
- * Can be mounted upside.

1.3. Working Principle

Capacitance definition, assuming two parallel conductive plates are used;

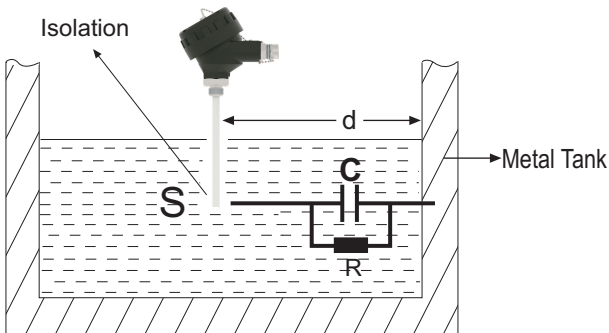

$$C = \frac{\epsilon_0 \cdot \epsilon_r \cdot S}{d}$$

C: Capacity , Farad

S: Surface Area , m²

d: Distance , m

However, there are scarcely any sensor type which this definition can be practically utilized.

Above Formula can no longer be reliable especially when residual areas increase due to large distance (d) (which is usually the case).

Thus, measuring impedance for distance measurements give more accurate results than capacitance measurement.

Capacity

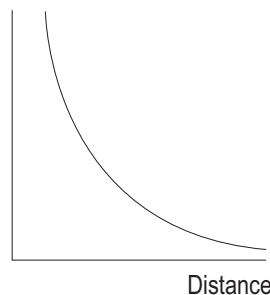

Impedance

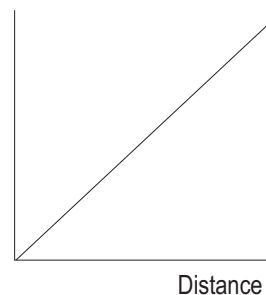

Impedance definition $Z = R + jL\omega + (jC\omega)^{-1}$ R is defined as real component and represent ambient conductivity.

$j\omega L$ second component is defined as inductive reactance. This component is present even if we perform capacitive measurement. However we neglect this. Since we evaluate results based on electrostatic properties of the environment, no error will occur. Resulting impedance definition is $Z = R + (jC\omega)^{-1}$.

Measurement is made by charge transfer in our capacitive sensors. Total impedance is defined as $Z = V / I$.

I (current) $I = Q/t$

Q (Coulomb)

T (sec)

Capacitive reactance we desire to measure is $(jC\omega)^{-1}$. Meaning that charge and impedance have the same phase.

To summarize, charge transferred to medium is directly proportional with capacitive reactance.

For sensors manufactured as coaxial;

a: Central electrode radius

b: Outer screen radius

L: length

$$C = \frac{2 \cdot \pi \cdot \epsilon_0 \cdot \epsilon_r \cdot L}{\ln(b/a)}$$

Impedance is calculated by this definition

Excitation applied between 10KHz...250KHz based on length for all our models. ($\omega = 2\pi \cdot f$)
Linearity error that may be caused by conductivity component (R) effect is prevented by electronic circuit design and mechanical design. Reduced to a level lower than 1ppm, acceptable as zero.

Process Pressure / Temperature Chart

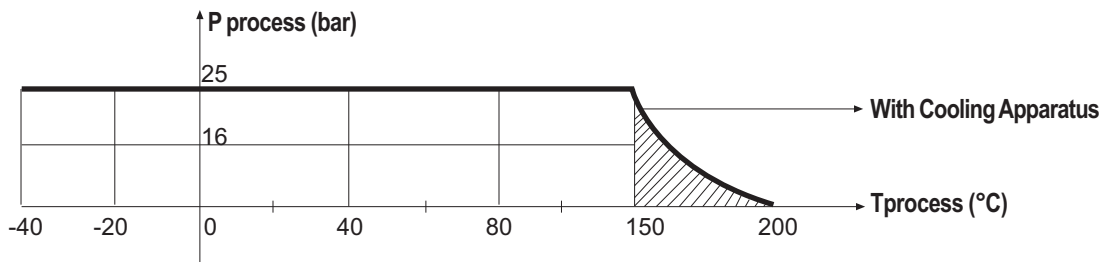

Environment Pressure / Temperature Chart

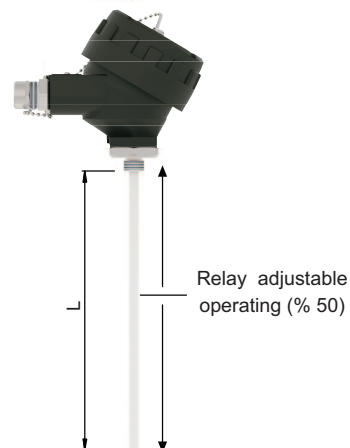
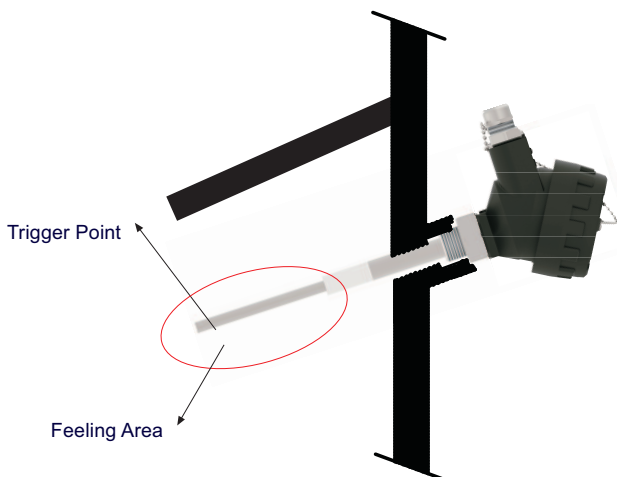
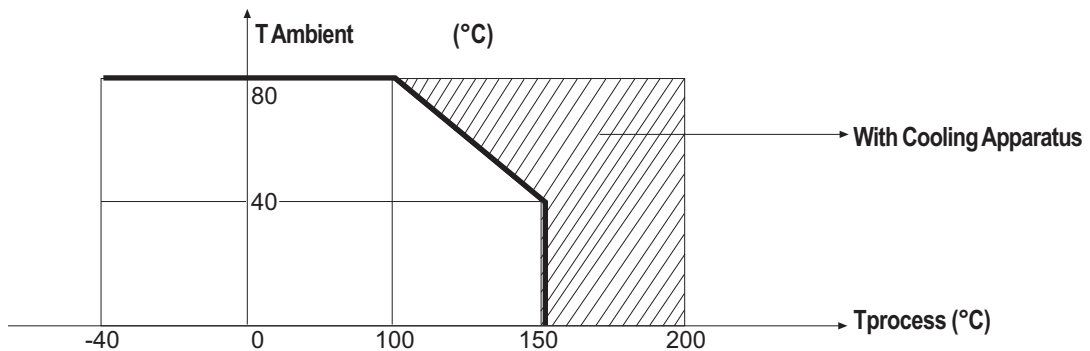

1.4. Technical Specifications and Material Knowledge

Technical Specifications :

Measurable Material	Non-conductive liquids Conductive liquids, refrigerants Solids particulate materials Adhesive and acid/basic liquids
Supply	9-36 VDC
Signal Output	1 NONC x5 A / 250 VAC Relay
Min.Di-Electric Constant	1,6 ϵ_r
Connection Material	304 St.St. Opt. 316 St.St.
Isolation Material	PTFE, PFA Opt. Peek, Ceramic
Housing Material	Aluminum Injection - AISI12Fe (Std) Black (RAL.9005)
Working Pressure	-1...25 bar (Depending on the model)
Working Temperature	(-) 40 / (+) 150 °C (Depending on the model) 200 °C with cooling apparatus 230 °C with PEEK isolation 400 °C with ceramic isolation
Ambient Temperature	(-) 20 °C...(+) 60 °C
Display	With LED-Power and Contact LED
Isolation	Max. 500 V
Power Consumption	Max. 1 W
Electrical Connection	Terminal
Protection Class(EN60529)	IP 66 / 68
Test	EMC, Low Voltage
Max. Tensile Force	Max. 40 NM
Weight	285 g. for DX-ECAS 101

Certification



II 1/2G Ex db ia IIC T6...T2 Ga/Gb For Gas
II 1/2D Ex tb ia IIIC T85°C...T300°C Da/Db For Dust
* Have a look at the temperature class chart.

1.5.Application Examples

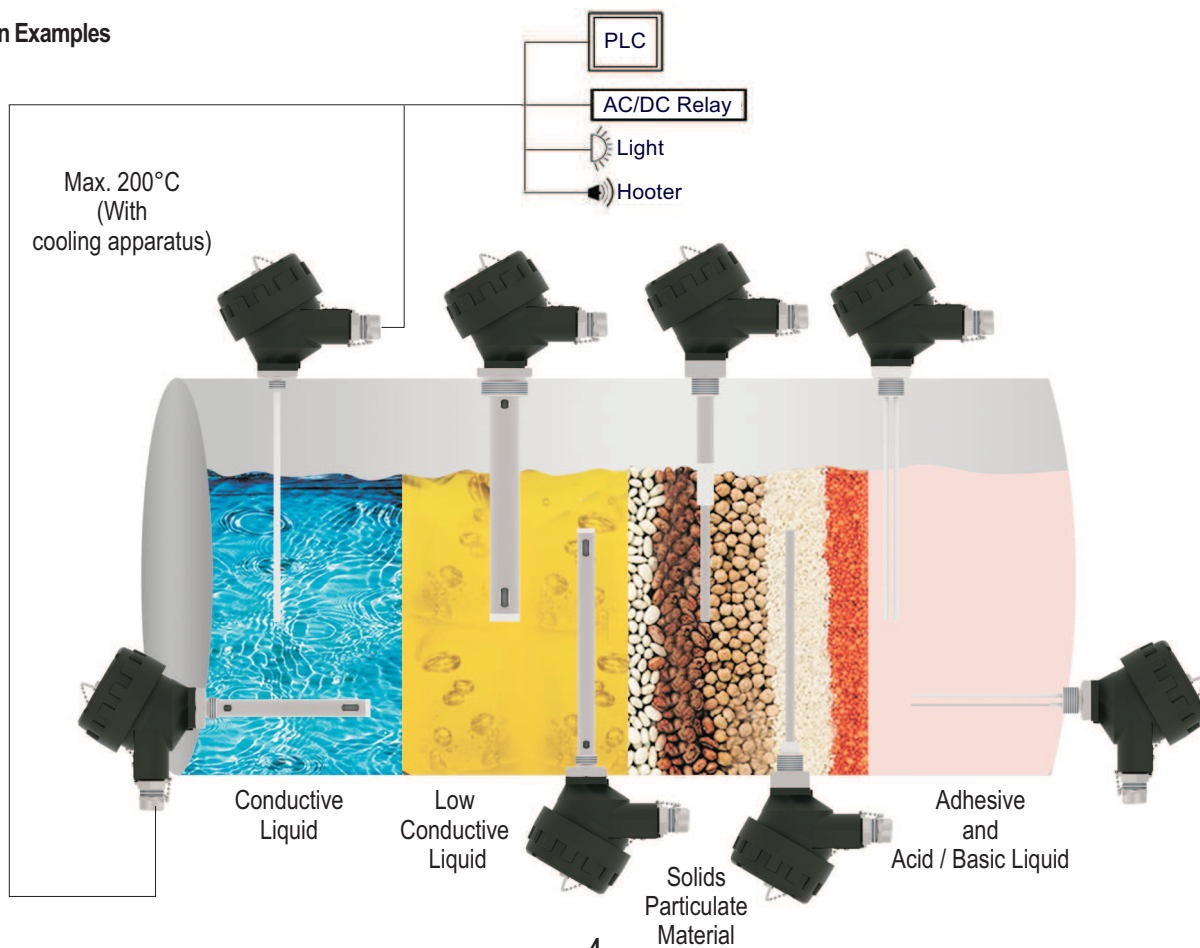

1.6. Label Information

Label:

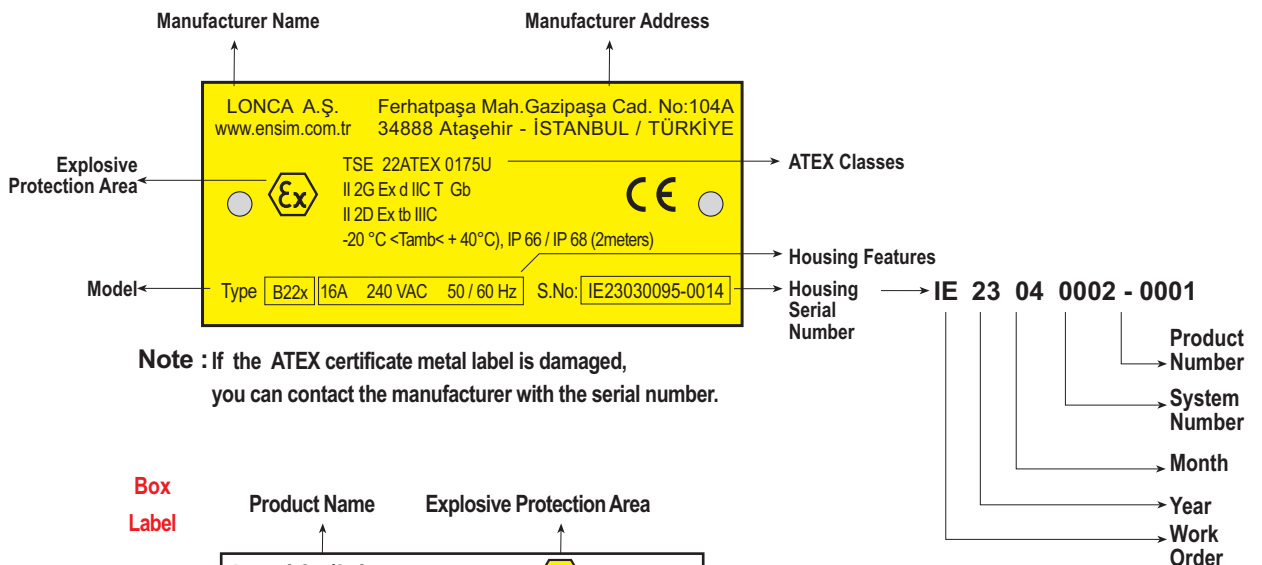
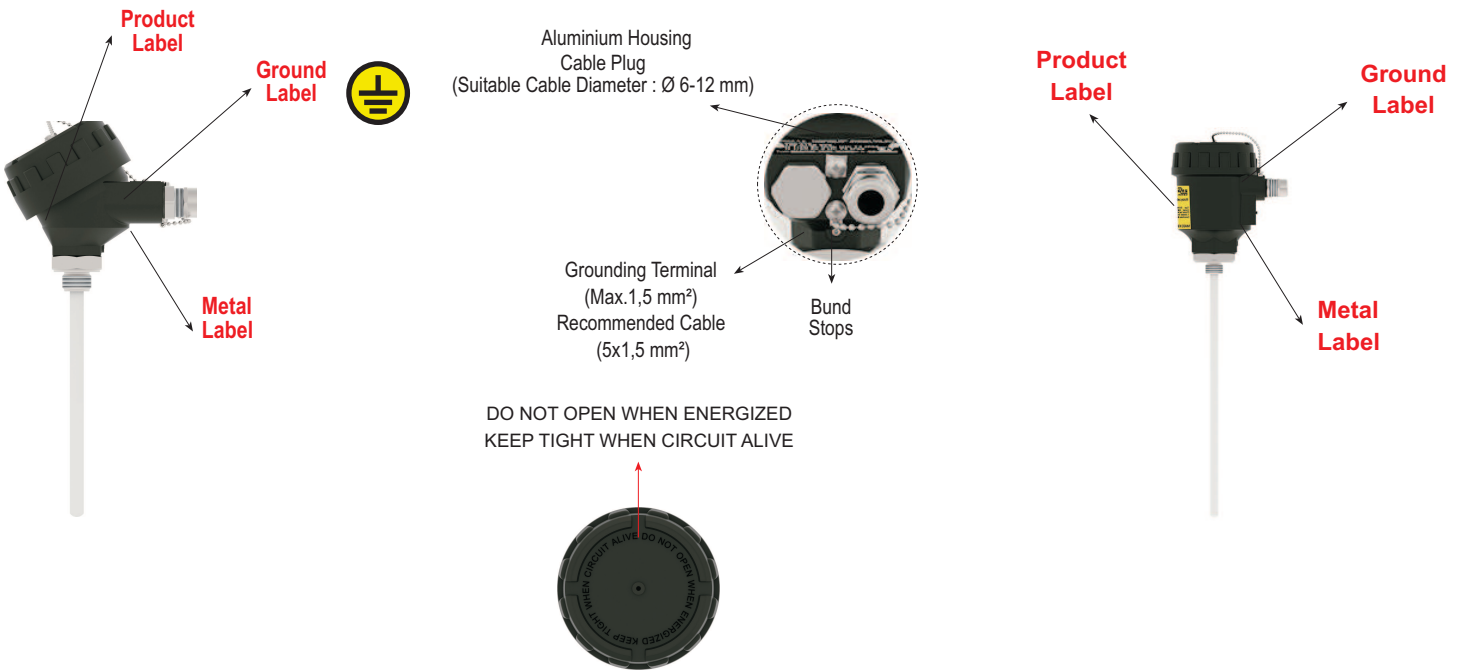
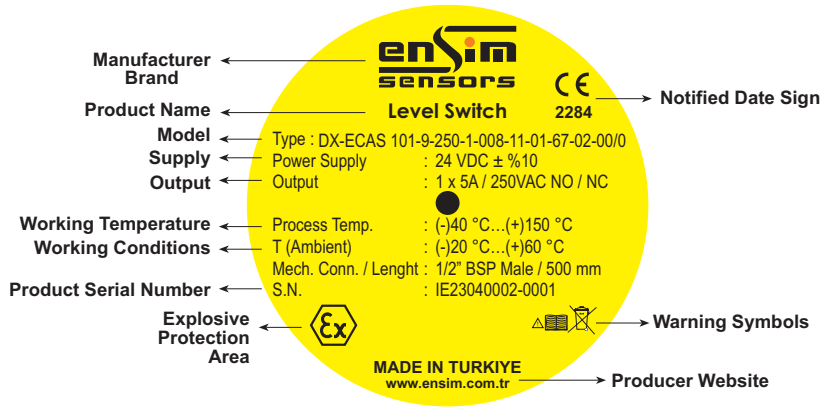

1.7. Package and package contents

Please check whether you have taken delivery of below listed content completely or not and check its conformity with criterions in your order:

***Capasitive Level Switch**

*This operating manual



Std. Package

1.8. Target Group

This operating manual has been prepared for qualified technical personnel.

1.9. Security Notes



Please consider below notes for avoiding hazardous cases around operator and it's environment.

Only users that authorized in work safety and whom also have read the manual should setup this equipment.

Work safety , accident avoid regulations and national/local setup standards must be meet.

Equipment should only be used in stated specifications.

Equipment must only be mounted while there is no pressure.

1.10. Certifications and Approvals

CE	:	It shows that, product meets required conditions of EU with CE stamp and stipulate that product passed quality assessment stages
ATEX (2014 / 34 / AB)	:	TS EN IEC 60079 - 0 : 2018 TS EN 60079 - 1 : 2014 TS EN 60079 - 11 : 2012 TS EN 60079 - 31 : 2014 TS EN 60079 - 26 : 2015
LVD (2014 / 35 / AB)	:	TS EN 60204 -1 : 2018
EMC (2014 / 108 / AT)	:	TS EN 61326 - 1 : 2021 TS 3033 EN 60529 : 2014

Note : All the features and tests on this document has manufactured with **DX-ECAS** models at LONCA Inc.

1.10. Safety Instructions (ATEX)



Safety instructions should be read and applied to the end.

- The following notes must be taken into attention to protect the operator and the environment from possible hazards.
- The device setup and maintenance of this device must be done by knowledgeable persons who has read the instructions and is familiar with the safety at work.
- It should be checked by the users that the products are fitted suitable to the zone maps.
- Work safety, must be observe by accident prevention regulations and national installation standards.
- The product should be used within the specification presented guideline.
- You can only mount the device when there is no pressure.
- These safety instructions are protected in terms of 1 / 2 D and 1 / 1 G category for **DX-ECAS** coded series and is compatible with IEP23ATEX1211X and CE certificate.
- The Label should be used in appropriate environments.
- Because the environment is max. 60 C you should choose a suitable cable for use.
- Do not over tighten the cable gland in order not to affect the IP protection class.
- Make sure the cable entry and plug is tightened right.
- Ground connection must be done properly and checked without energizing.
- Before starting use make sure the lid is fully closed and the set screw is tightened.
- DX-ECAS** models are metal protected. It is Compatible with different supply voltages specified in the catalog.
- The metal enclosure must be in the 2D or 2G zone. **The pipe and float** section must be located in the 1D and 1G zone.
- Max. working temperature, max. Surface temperature can change depending on the model, Please read the document carefully before using.
- During the mounting it should be checked that there is no mechanical stress or deformation in the tank wall. When this happens, the sensor should not be energized without the necessary correction measures.
- Check that the pressure in the tank hasnt exceed the pressure shown in the catalog.
- The mounting sensor must be mount properly in the tank filling system. In case it is not suitable, the sensor must be protected and the in-tank apparatus must be protected.

- Flange surface smoothness must be maintained in flanged connection.
- Flange seating surface should not be scratched, and suitable liquid gasket should be used instead of sealing with gasket in counter flange mounting.
- Flanged connections are welded with the sensor part.

- The sensor is designed to withstand the chemical effects of the materials. Check the suitability of different materials.
- The Sensors are in suitable storage conditions and protected from dust and damp.
- Device repairs should only be done at the manufacturer Lonca Inc.
- Protect the device from friction and cleaning should be done without water.
- In case of improper circuit conditions, the main energy must be completely disconnected and safety measures should be taken without replacing the temperature circuit breaker with its backup. Changes should be made in a safe area.

1.12. ATEX Marking Sample Description

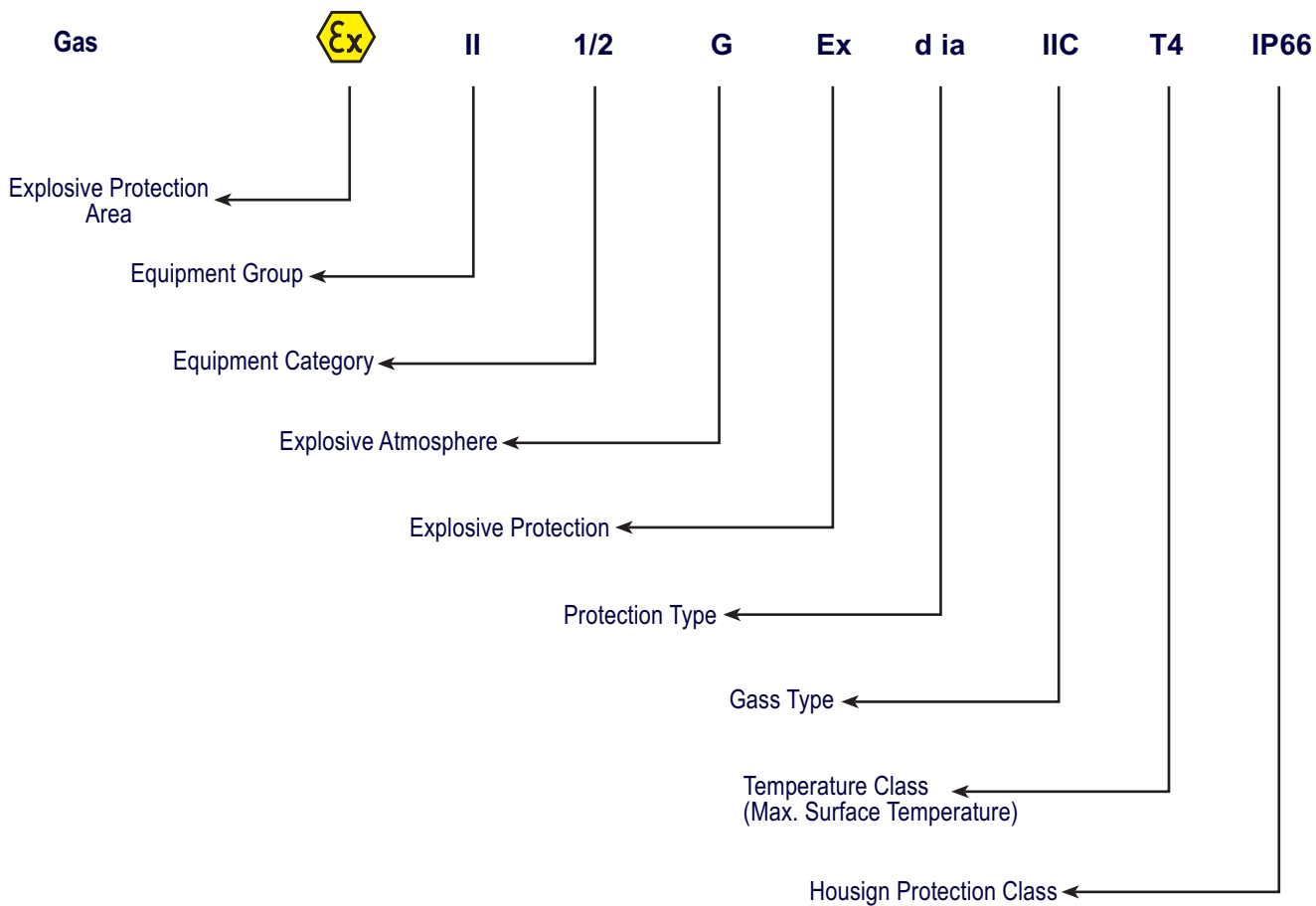
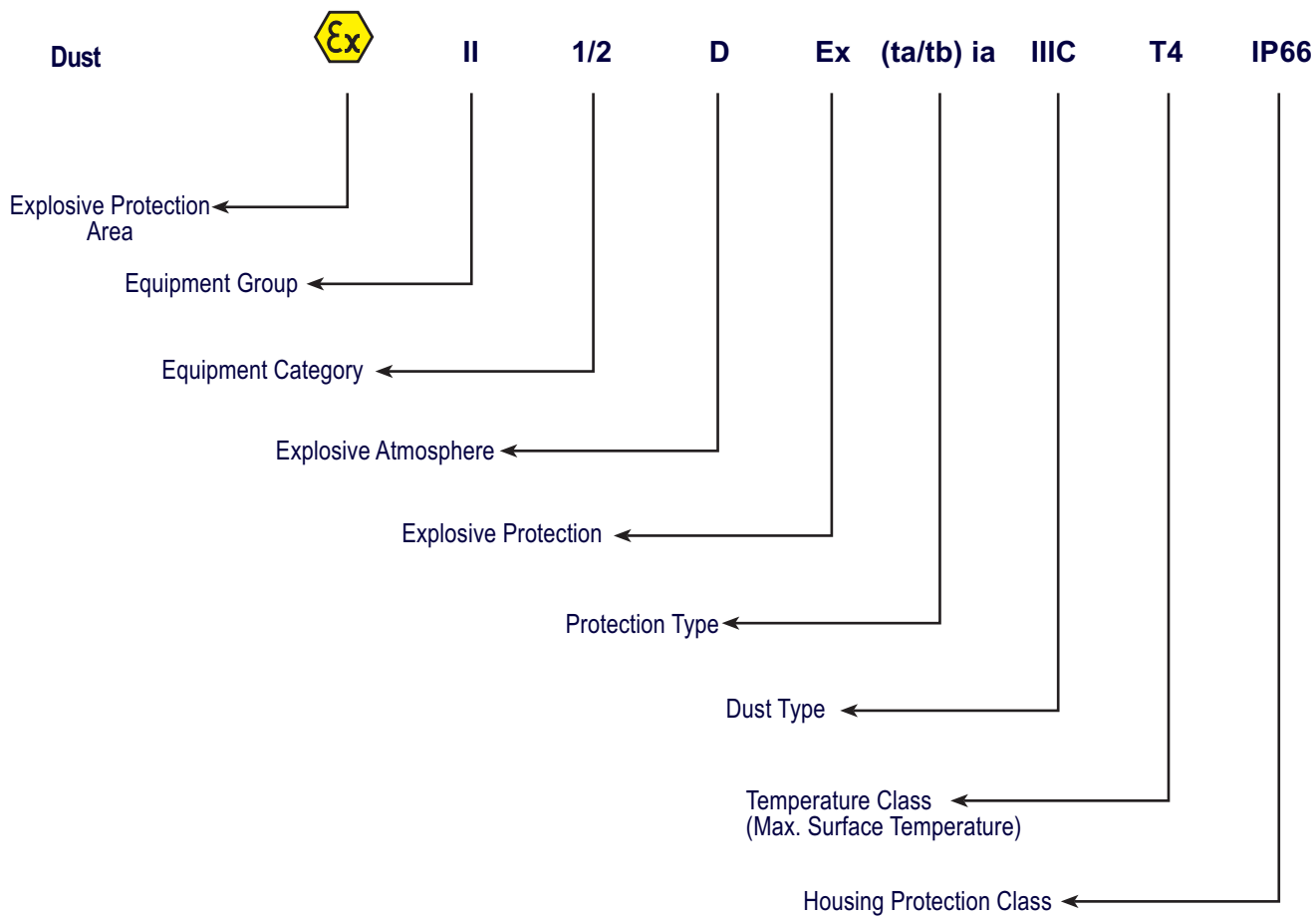

2. Installation :

2.1. General Notes :

The device installation is in 2014 / 34 / EU criteria to ensure the safety of atmosphere and people from explosions, must only be done by staff who knows the safeguards.

Do not apply force to the instrument during the installation!

Do not use the **Capacitive Level Switch** with a greater pressure than recommended pressure.

Do not forget that instrument is precise, carry it carefully and prevent not to be damaged.

It should be guaranteed that there are not any magnetic particles.

The Max. working pressure should not be exceeded.

2.2. General Installation Stages

*Remove **Capacitive Level Switch** from the box carefully

*Check whether gasket is appropriate for fluid or not. If is not appropriate, contact with the producer.

*Then, apply below mentioned explanations according to structure of the design.

2.3. Special Notes

*Please ensure that there is no mechanical stress on the shaft following installation. Such case will cause slipping in the characteristic curve.

***Capacitive Level Switch** must be placed upright or horizontal.

*Allocate valve certainly in the process connection while instrument is used.

*Allocate blowdown valve under bottom flange for blowdown.

*If instrument is mounted outside and if there is any danger of lightning or excessive pressure, take preventive measures by taking necessary measures.

*In the operating conditions, **Capacitive Level Switch** may be hot according to situation of fluid, in this case, do not touch the indicator, otherwise your skin is damaged.

*The grounding product must be done properly. (can be done outside or in housing)

2.4. Installation For Mechanical Connections

*Use appropriate O-Ring or gasket for tightness.

*Ensure that its surface is clean and smooth.

*Assemble the instrument manually.

*Connect the contacts as shown in the figure.

(For G1" max. 20 Nm, G 1 1/4", for G" 1 1/2" max. 30Nm)

2.5. Parts

Housing :

ORDER CODE	TYPE	MATERIAL	PROTECTION CLASS	TEMPERATURE (°C)	SIZE a x b (mm)
750	B22x	Aluminium	IP 66 /68	(-) 40...(+) 200	117 x 102
704	B21x	Aluminium	IP 66 /68	(-) 40...(+) 200	132 x 104

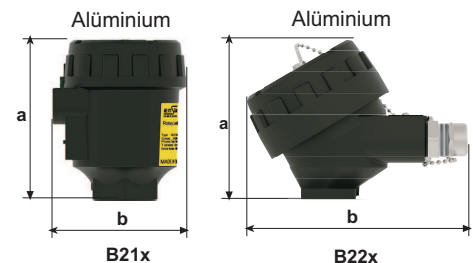

Cover Seal : NBR Nitrile Rubber 120 °C, Opt. FPM (Viton) 200 °C)

EU-Type Examination Certificate Number : TSE 22ATEX 0175U

The marking of the equipment :



Cooling:

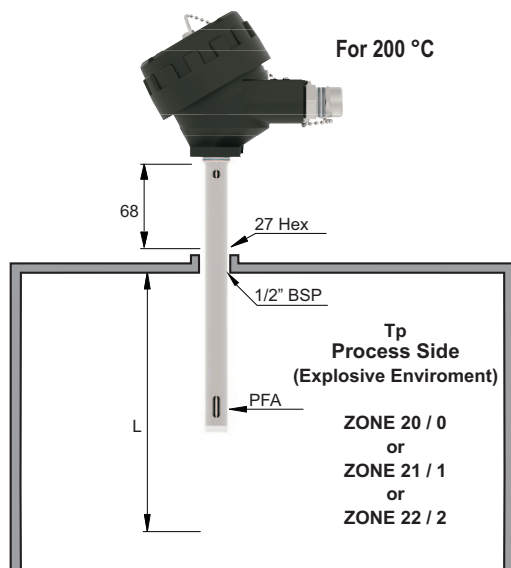

Protection Case:

Material : 304 Stainless Steel
Welded manufacturing
Opens - Closes Hinged
To Protect Against external conditions.



Ta
Factory Area
(Safe)

ZONE 21 / 1
or
ZONE 22 / 2

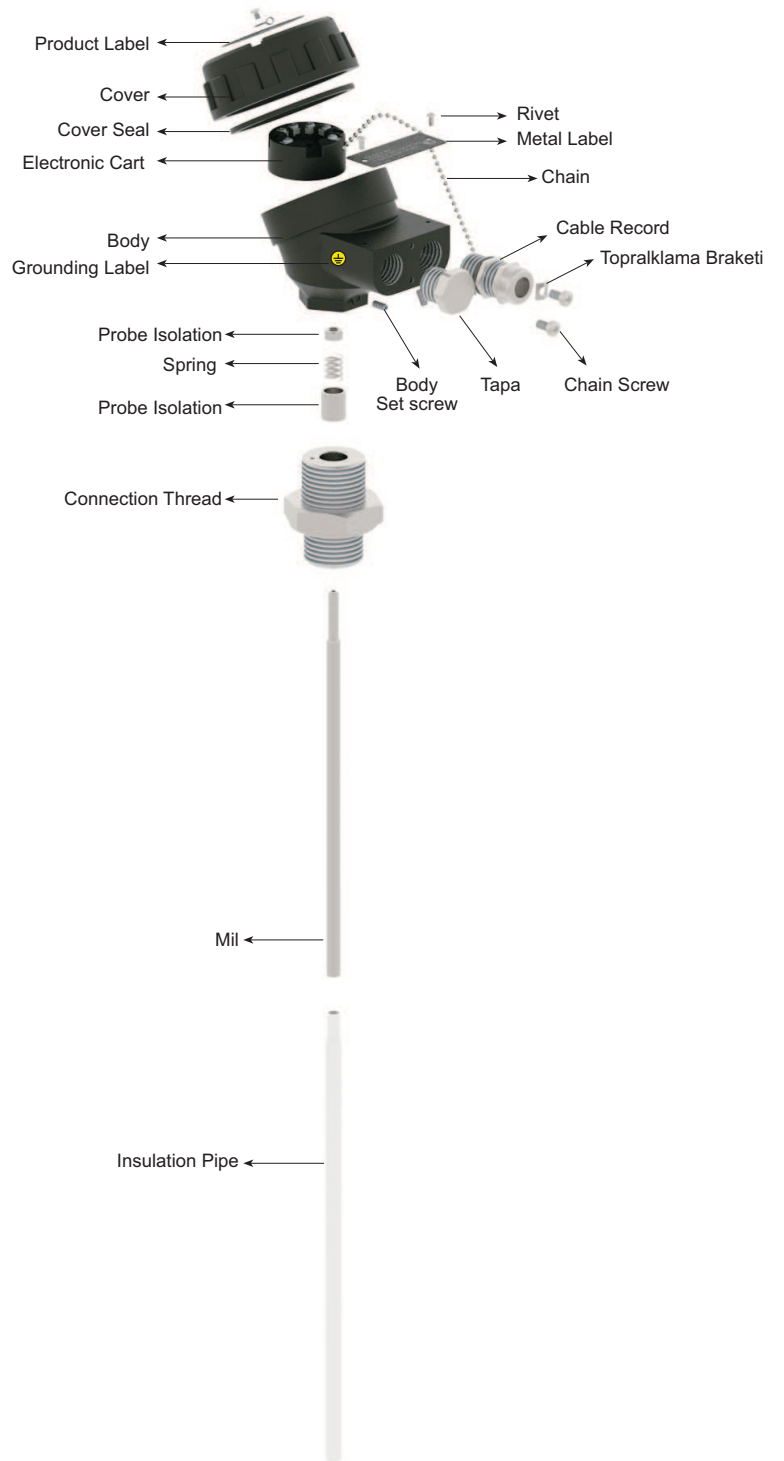
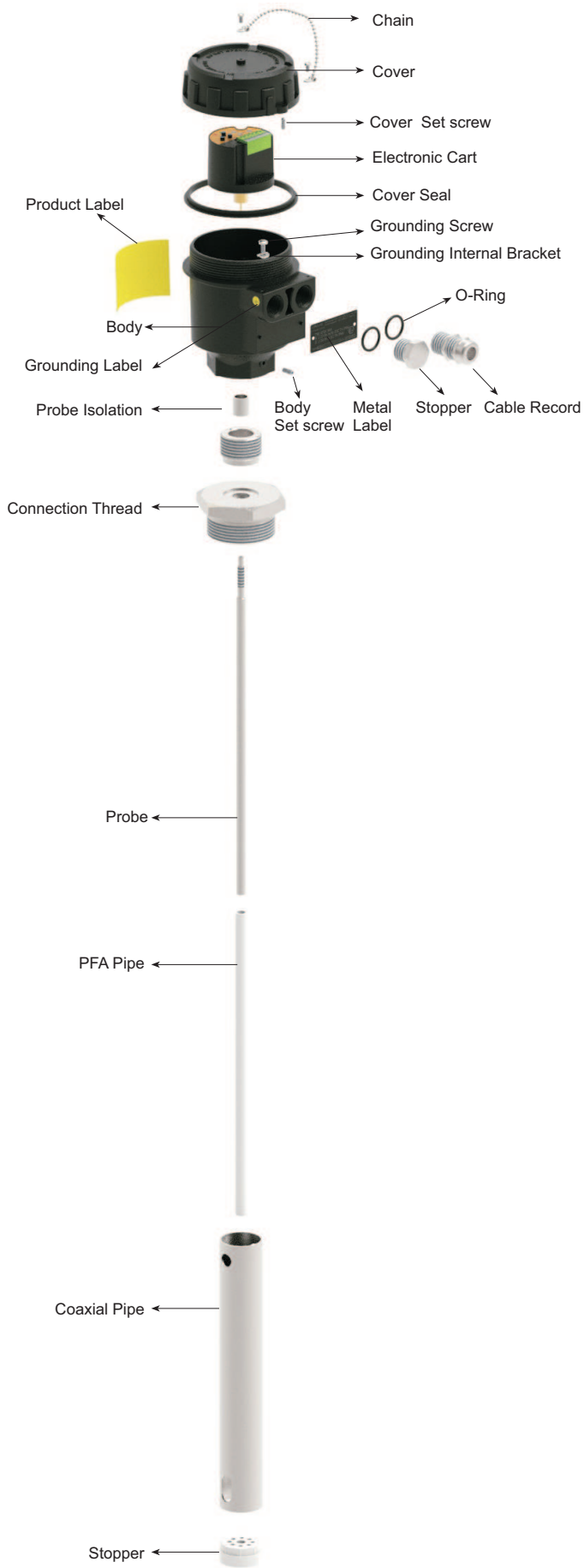

2.6. Maximum Surface Temperature

Temperature Class Table

(-) 20° C ≤ Ta Ambient ≤ (+) 30° C...(+) 60° C		Working Temperature: (-) 20° C ... (+) 80° C / 90° C / 125° C / 190° C / 250° C		Group II
MODEL DX-ECAS101 - DX-ECAS102 - DX-ECAS103 - DX-ECAS107 DX-ECAS202 - DX-ECAS203 - DX-ECAS204 - DX-ECAS205 - DX-ECAS20S DX-ECAS301 - DX-ECAS304 - DX-ECAS30D DX-ECAS408A				
Without opening the cover standby time		30 min.	(-)40...(+)150° C	40 min. (-)40...(+)200° C
Ta AMBIENT TEMPERATURE	TP PROCESS TEMPERATURE	TEMPERATURE CLASS		
60° C	< 80° C	T6		
60° C	< 90° C	T5		
60° C	< 125° C	T4		
60° C	< 190° C	T3		
60° C	< 250° C	T2		

(-) 20° C ≤ Ta Ambient ≤ (+) 30° C...(+) 60° C		Working Temperature: (-) 20° C ... (+) 60° C		Group III
MODEL DX-ECAS101 - DX-ECAS102 - DX-ECAS103 - DX-ECAS107 DX-ECAS202 - DX-ECAS203 - DX-ECAS204 - DX-ECAS205 - DX-ECAS20S DX-ECAS301 - DX-ECAS304 - DX-ECAS30D DX-ECAS408A				
Without opening the cover standby time		10 min.	(-)40...(+)60° C	
Ta AMBIENT TEMPERATURE	TP PROCESS TEMPERATURE	TEMPERATURE CLASS		
60° C	< 60° C	T6		

2.7. Electrical Connection :

Make the electrical connection of the instrument according to details on its label, table and cable figures in this manual

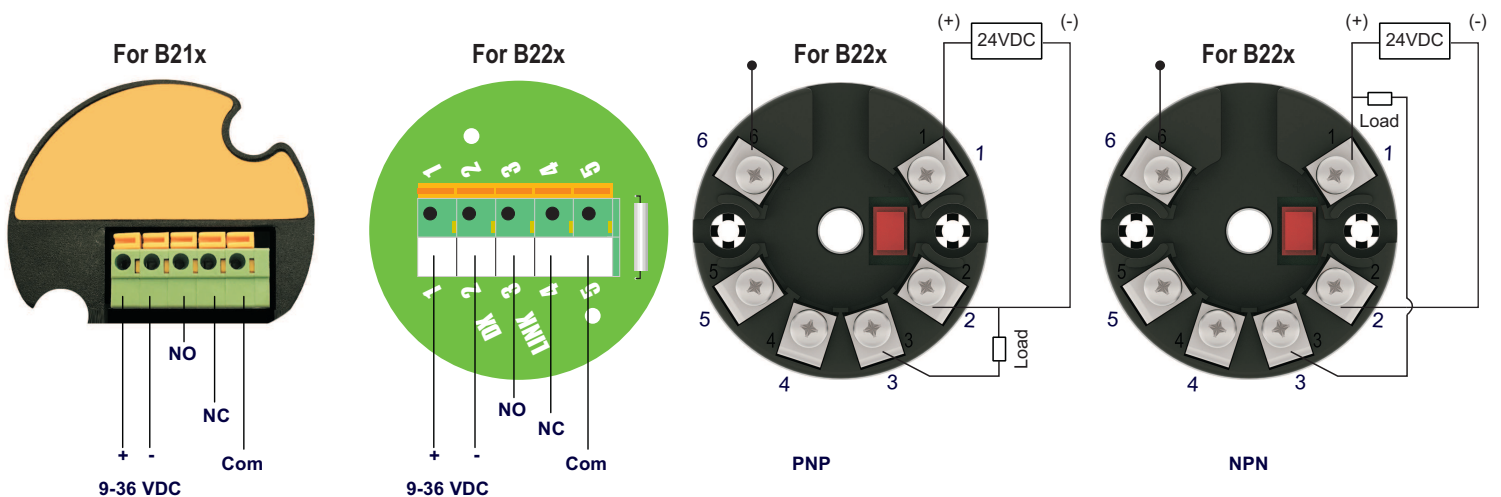

Input Signals

Channel 1

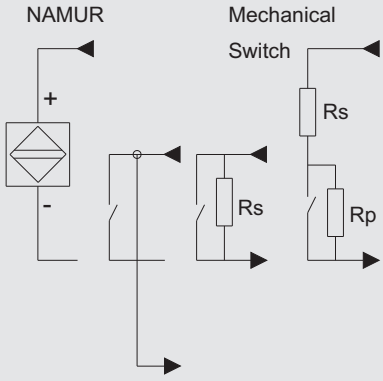

**Zone 0,1,2
20,21,22,M1 &
Cl. I/II/III, Div. 1
gr. A-G**

Output Signals

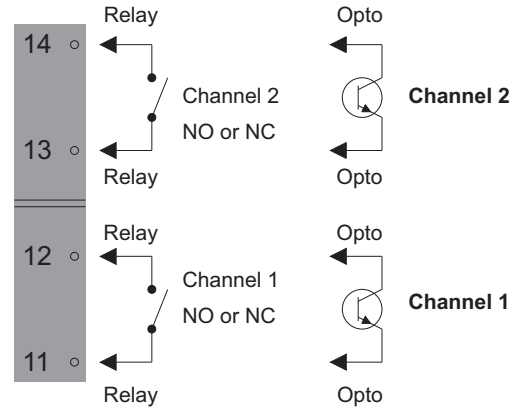

**Zone 2 & Cl. 1,
Div. 2, gr. A-D
or Safe Area**

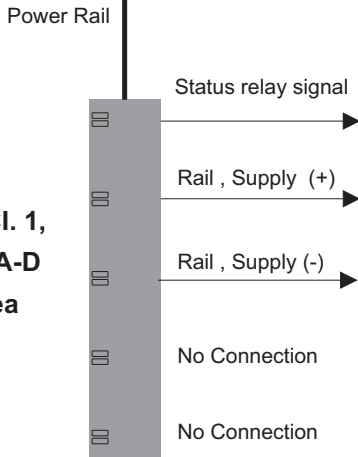

Channel 2

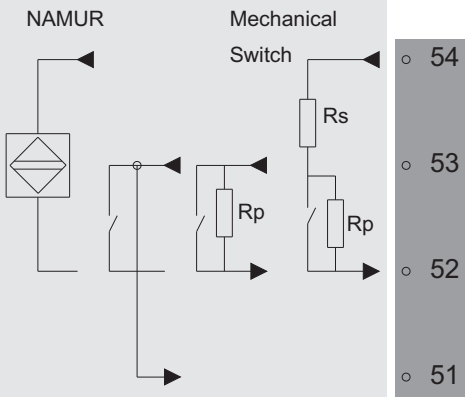

Power Connection :

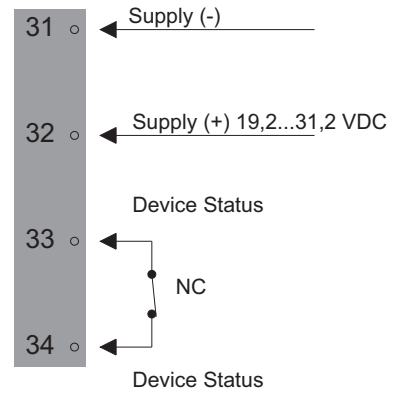

Supply via power rail

2.8. Connection Accessories

Thread (Connection has been welded with sensor)

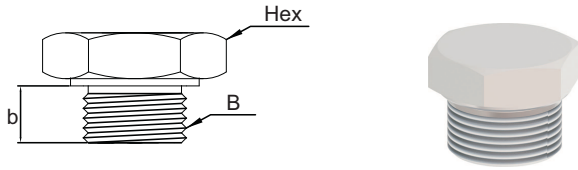

(ISO228-1)

Order Code	Dimension B	Hex [mm]	Stem Length b [mm]
0003	3/8"BSP	50	20
0004	1/2"BSP	50	14
0005	3/4"BSP	50	14
0006	1"BSP	50	23
0008	1 1/4"BSP	50	23
0009	1 1/2"BSP	60	23
0012	2"BSP	70	23

Flanged (Connection has been welded with sensor)

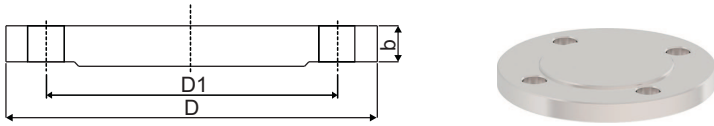

Order Code	(ISO1092-1) PN 16	D (mm)	D1 (mm)	b (mm)
0502	DN25	165	85	16
0503	DN32	140	100	16
0505	DN50	165	125	18
0507	DN80	200	160	20
0508	DN100	220	180	20

Order Code	(ISO1092-1) PN 40	D (mm)	D1 (mm)	b (mm)
0702	DN25	115	85	18
0703	DN32	140	100	20
0705	DN50	165	125	20
0707	DN80	200	160	20
0708	DN100	235	190	24

Order Code	(ANSI B16.5) 150 LBS	D (mm)	D1 (mm)	b (mm)
1005	DN50	152,4	121	19
1006	DN65	177,8	139,7	22,2
1007	DN80	190,5	152,4	23,8
1008	DN100	228,6	157,2	23,8

Clamp (Connection has been welded with sensor)



Order Code	(ISO2852) Dimension	Dia. D (mm)	b (mm)
1501	DN32	50,5	15
1502	DN50	64	17
1503	DN65	91	17

Dairy (Connection has been welded with sensor)

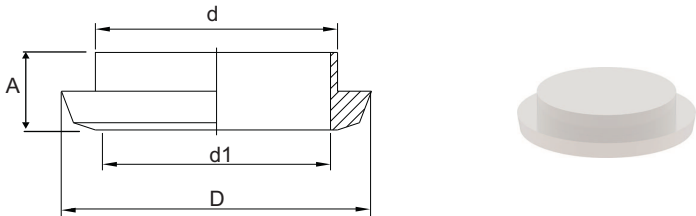

Order Code	Dimension	Dimension D (mm)	d1 (mm)	A (mm)	
1600	DN40	DN40	56	48	13
1601	DN50	DN50	68	61	14
1602	DN100	DN100	121	114	20

CONDUCTIVE LIQUIDS

Sample Models:

DX-ECAS 101
Fully Insulated Probe
Conductive Tank

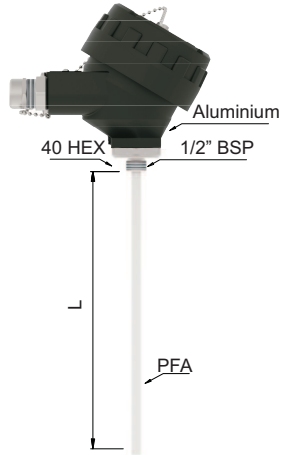

L=250 mm.(Std) Max. 4 m.
(-) 1 bar...(+) 25 bar
(-) 40 °C...(+) 150 °C

DX-ECAS 102
Fully Insulated Coaxial Probe
Insulated Tank

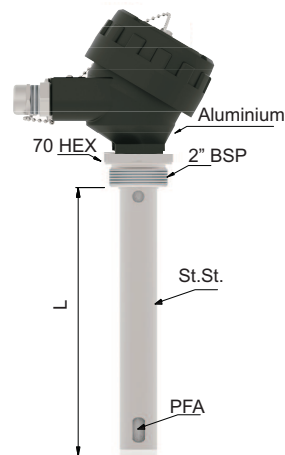

L=250 mm.(Std) Max. 4 m.
(-) 1 bar...(+) 25 bar
(-) 40 °C...(+) 150 °C

DX-ECAS 103
Fully Insulated Coaxial Probe
Insulated Tank

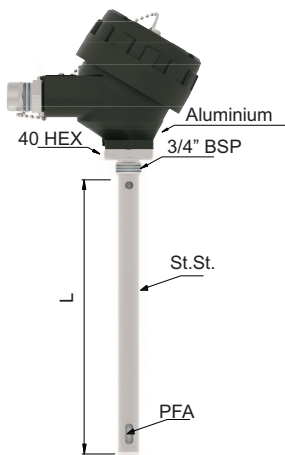

L=250 mm.(Std) Max. 1 m.
(-) 1 bar...(+) 25 bar
(-) 40 °C...(+) 150 °C

DX-ECAS 107
Fully Insulated Rope
Conductive Tank

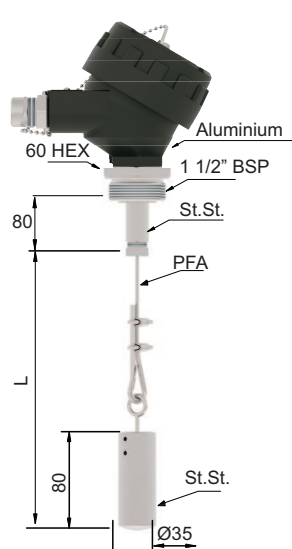

L=1 m.(Std) Max. 16 m.
(-) 1 bar...(+) 25 bar
(-) 40 °C...(+) 150 °C

DX-ECAS 107
Fully Insulated Rope
Conductive Tank

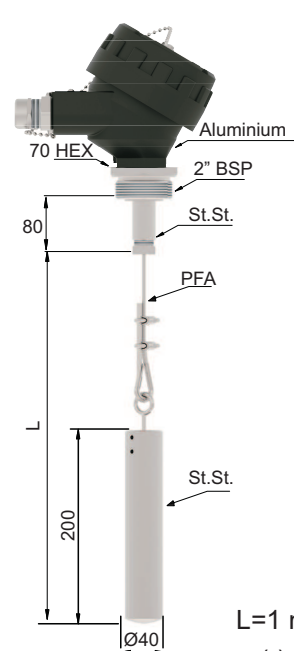

L=1 m.(Std) Max. 32 m.
(-) 1 bar...(+) 25 bar
(-) 40 °C...(+) 150 °C

LOW CONDUCTIVE LIQUIDS

Sample Models:

DX-ECAS 202

Partly Insulated Coaxial Probe
Conductive / Insulating Tank

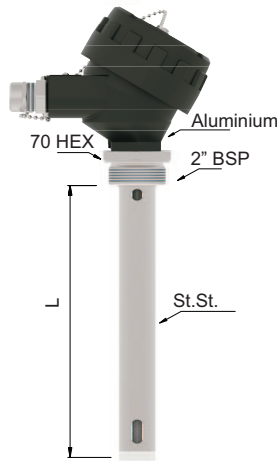

L=250 mm.(Std) Max. 4 m.
(-) 1 bar...(+) 25 bar
(-) 40 °C...(+) 150 °C

DX-ECAS 203

Partly Insulated Coaxial Probe
Conductive / Insulating Tank

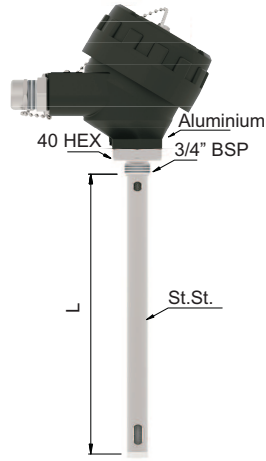

L=250 mm.(Std) Max. 1 m.
(-) 1 bar...(+) 25 bar
(-) 40 °C...(+) 150 °C

DX-ECAS 20S

İzolesiz Koaksiyel Prob
İletken / Yalıtkan Tank

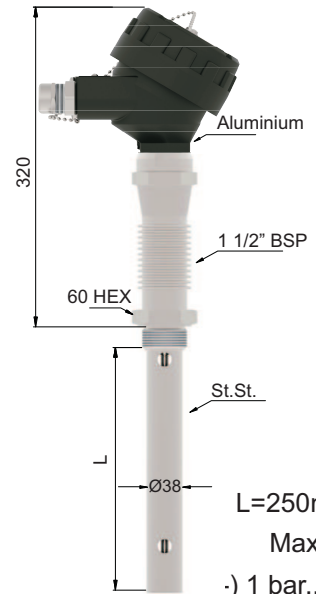

L=250mm.(Std)
Max. 4 m.
(-) 1 bar...(+) 25 bar
(-) 40 °C...(+) 400 °C

DX-ECAS 204

Partly Insulated Rope
Conductive Tank

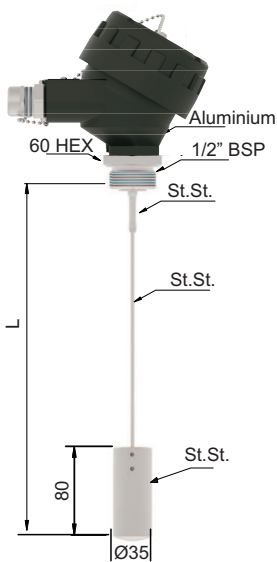

L=1 m.(Std) Max. 16 m.
(-) 1 bar...(+) 25 bar
(-) 40 °C...(+) 150 °C

DX-ECAS 204

Partly Insulated Rope
Conductive Tank

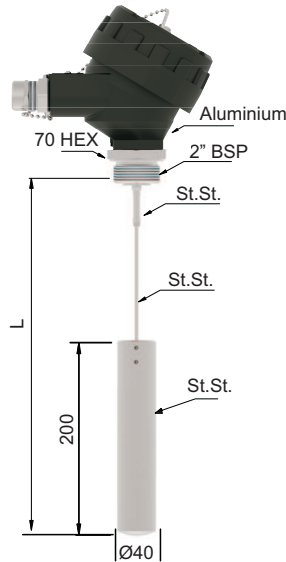

L=1 m.(Std) Max. 32 m.
(-) 1 bar...(+) 25 bar
(-) 40 °C...(+) 150 °C

DX-ECAS 205

Partly Insulated Probe
Conductive Tank

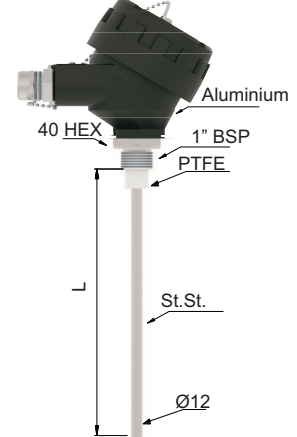

L=250 mm.(Std) Max. 6 m.
(-) 1 bar...(+) 25 bar
(-) 40 °C...(+) 150 °C

SOLID PARTICULATE MATERIALS

Sample Models:

DX-ECAS 301

Compled Insulated Probe
Conductive Tank



L=250 mm.(Std) Max. 1 m.
(-) 1 bar...(+) 25 bar
(-) 40 °C...(+) 150 °C

DX-ECAS 305

Partly Insulated Probe
Conductive Tank

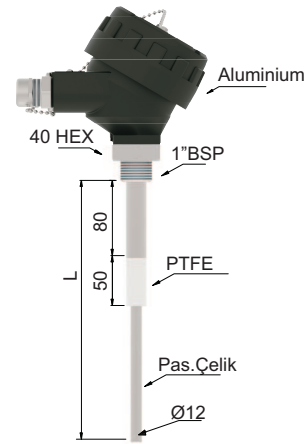

L=250 mm.(Std) Max. 6 m.
(-) 1 bar...(+) 25 bar
(-) 40 °C...(+) 150 °C

DX-ECAS 304

Partly Insulated Rope
Conductive Tank

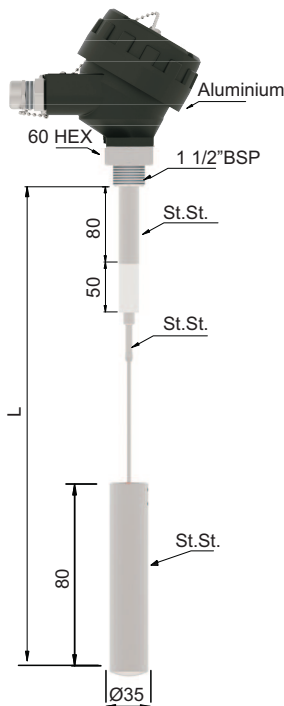

L=1000 mm.(Std) Max. 16 m.
(-) 1 bar...(+) 25 bar
(-) 40 °C...(+) 150 °C

DX-ECAS 30D

Double Partly Insulated Probe
Insulating Tank

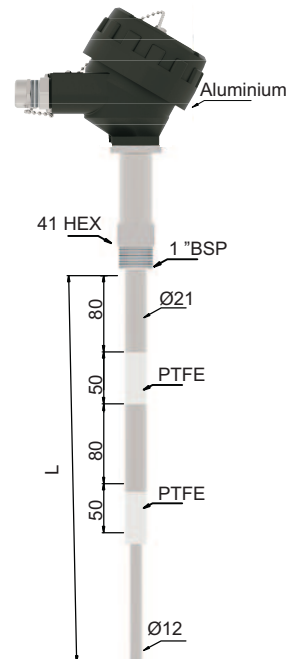

L=380 mm.(Std) Max. 1 m.
(-) 1 bar...(+) 25 bar
(-) 40 °C...(+) 200 °C

ADHESIVE AND ACID / BASIC LIQUIDS

Sample Models:

ECAS 408A

Double Probe (Single Fully Insulated)
Conductive / Insulating Tank

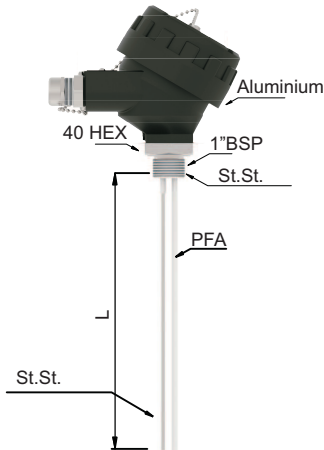

L=250 mm.(Std) Max. 4 m.

(-) 1 bar...(+) 25 bar

(-) 40 °C...(+) 150 °C

ECAS 408A

Double Probe (Single Fully Insulated)
Conductive / Insulating Tank

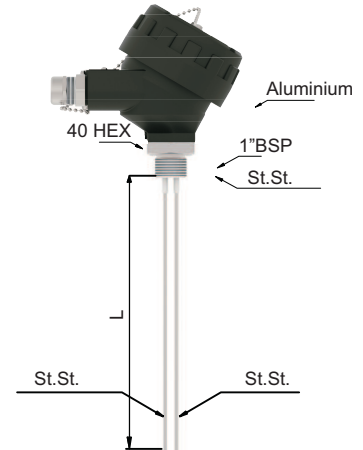

L=250 mm.(Std) Max. 6 m.

(-) 1 bar...(+) 25 bar

(-) 40 °C...(+) 150 °C

ECAS 408A

Double Probe (Single Fully Insulated)
Conductive / Insulating Tank

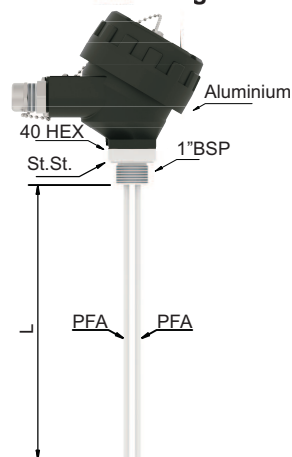

L=250 mm.(Std) Max. 1 m.

(-) 1 bar...(+) 25 bar

(-) 40 °C...(+) 150 °C

2.10. Order Form

Please consider sample models when coding!.. (Lined spaces defines the standard code)

1	MODEL DX-ECAS	Conductive Liquids.....1 Low Conductive Liquids2	Solids Particulate Materials.....3 Adhesive and Acid/Basic Liquids.....4
2	CERTIFICATE	No.....0	(EN10204-3-1) Material Certification.....1
3	PROBE TYPE (MAX. LENGHT)	Single Probe - Insulated (Max 4 m) 1 Single Probe - Coaxial (max 4 m) Ø 38 2 Single Probe - Thin Coaxial (max 1 m), Ø21 3 Rope - Partly Insulated (Max 32 m).....4 Single Probe - Partly Insulated (Max 6 m) 5 Single Probe - High Temperature (Max 4 m) 6 Rope - Fully Insulated (0 ... 32 m) 7	Double Probe - Single Fully Insulated (Max 4 m) 8A Ceramic Partly Insulated Probe (Max 4 m) S Double Fully Insulated Probe (Max 4 m) D Special x

4	PROBE DIAMETER (Ø)mm	Special x
----------	---------------------------	---------	-----------------

5	STEM LENGHTmm
----------	--------------------	---------

6	PROCESS TEMPERATURE	150 °C Standard0 200 °C with Cooling Apparatus1	(-)196°C For Cryogenic Tank2 230°C with Peek Insulated3 400°C with Seramic Insulated4
----------	----------------------------	--	---

7	CONNECTION	<table border="1"> <thead> <tr> <th>Thread (ISO 228-1)</th> <th>Clamp (ISO 2852)</th> <th>ISO Flange(1092-1)</th> <th>ISO Flange (1092-1)</th> <th>ASA Flanged (B16.5)</th> </tr> </thead> <tbody> <tr> <td>1/2" BSP.....0004</td> <td>DN 25 - PN 16 ... 0502</td> <td>DN 25 - PN 16...0502</td> <td>DN 25 - PN 40...0702</td> <td>DN 50 - 150lb ... 1005</td> </tr> <tr> <td>3/4" BSP0005</td> <td>DN 32 - PN 16 ... 0503</td> <td>DN 32 - PN 16...0503</td> <td>DN 32 - PN 40...0703</td> <td>DN 65 - 150lb ... 1006</td> </tr> <tr> <td>1" BSP.....0006</td> <td>DN 50 - PN 16 ... 0504</td> <td>DN 50 - PN 16...0505</td> <td>DN 50 - PN 40...0705</td> <td>DN 80 - 150lb ... 1007</td> </tr> <tr> <td>1 1/2" BSP.....0010</td> <td></td> <td>DN 80 - PN 16...0507</td> <td>DN 80 - PN 40...0707</td> <td>DN 100 - 150lb ... 1008</td> </tr> <tr> <td>2" BSP.....0012</td> <td></td> <td>DN 100 - PN 16...0508</td> <td>DN 100 - PN 40...0708</td> <td></td> </tr> <tr> <td>1/2" NPT.....0203</td> <td></td> <td></td> <td></td> <td></td> </tr> <tr> <td>3/4" NPT.....0204</td> <td></td> <td></td> <td></td> <td></td> </tr> </tbody> </table>	Thread (ISO 228-1)	Clamp (ISO 2852)	ISO Flange(1092-1)	ISO Flange (1092-1)	ASA Flanged (B16.5)	1/2" BSP.....0004	DN 25 - PN 16 ... 0502	DN 25 - PN 16...0502	DN 25 - PN 40...0702	DN 50 - 150lb ... 1005	3/4" BSP0005	DN 32 - PN 16 ... 0503	DN 32 - PN 16...0503	DN 32 - PN 40...0703	DN 65 - 150lb ... 1006	1" BSP.....0006	DN 50 - PN 16 ... 0504	DN 50 - PN 16...0505	DN 50 - PN 40...0705	DN 80 - 150lb ... 1007	1 1/2" BSP.....0010		DN 80 - PN 16...0507	DN 80 - PN 40...0707	DN 100 - 150lb ... 1008	2" BSP.....0012		DN 100 - PN 16...0508	DN 100 - PN 40...0708		1/2" NPT.....0203					3/4" NPT.....0204				
Thread (ISO 228-1)	Clamp (ISO 2852)	ISO Flange(1092-1)	ISO Flange (1092-1)	ASA Flanged (B16.5)																																						
1/2" BSP.....0004	DN 25 - PN 16 ... 0502	DN 25 - PN 16...0502	DN 25 - PN 40...0702	DN 50 - 150lb ... 1005																																						
3/4" BSP0005	DN 32 - PN 16 ... 0503	DN 32 - PN 16...0503	DN 32 - PN 40...0703	DN 65 - 150lb ... 1006																																						
1" BSP.....0006	DN 50 - PN 16 ... 0504	DN 50 - PN 16...0505	DN 50 - PN 40...0705	DN 80 - 150lb ... 1007																																						
1 1/2" BSP.....0010		DN 80 - PN 16...0507	DN 80 - PN 40...0707	DN 100 - 150lb ... 1008																																						
2" BSP.....0012		DN 100 - PN 16...0508	DN 100 - PN 40...0708																																							
1/2" NPT.....0203																																										
3/4" NPT.....0204																																										

8	OUTPUT	Relay Output (NO/NC) (5A).....11	Special.....x
----------	---------------	----------------------------------	---------------

9	HOUSING	Aluminium Housing, B21x IP66 / 68 (Std.).....750 Aluminium Housing, B21x IP66 / 68.....704	Special.....x
----------	----------------	---	---------------

10	INSULATION MATERIAL	PBT.....065 PTFE.....066 PFA.....067 PEEK.....068	Polyamide.....069 Ceramic.....070 Rubber.....081 FKM.....084 Special.....x
-----------	----------------------------	--	--

11	CONNECTION MATERIAL	316 Stainless Steel.....002 Brass.....041	Special.....x
-----------	----------------------------	--	---------------

12	ELECTRICAL CONNECTION	With Terminal.....00	Special.....x
-----------	------------------------------	----------------------	---------------

13	OPTIONAL	No...../ 0 Shetter (For the outside of the tank) 304 St.St. ./ K2	Wall Apparatus...../ W Zener Baryer 9202B-BIB Single Channel.../B1B Zener Barier 9202B-B2B Double Channel../B2B Special...../ x
-----------	-----------------	--	--

SAMPLE

DX-ECAS 101 - 10 - 300- 0 - 0006 - 11 - 750 - 066 - 002 - 00 / 0
For Cond. Liquid, L=300 mm, 1" BSP, Relay Output, Aluminium Housing B22x , Ø 10 Probe

2.11.

WARNING !!!



Please pay attention to following matters in order to operate your flow switch properly.

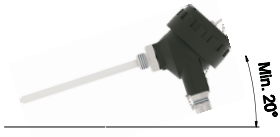

When connecting the switch to the tank
Connect with 20 degree angle.

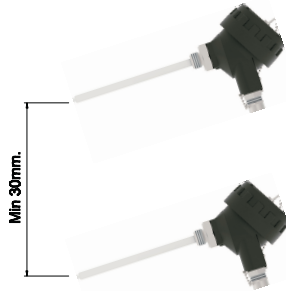

Switch from 30 cm each other
do not connect close



Please keep away from magnetic materials
like iron board ; otherwise the
characteristics might be affected



Please do not drop ,
otherwise the characteristics
might be changed.

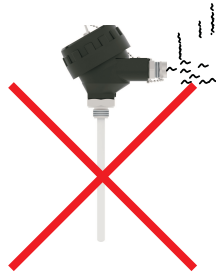

Please do not dip cables
potting into liquids, otherwise
instulation problem may cause.



Do not fasten switch reversely ,
otherwise its characteristics
might be changed.



Vibration might be caused instability.

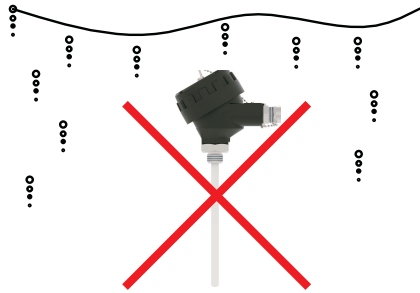

Do not fasten switch reversely ,
otherwise its characteristics
might be changed.

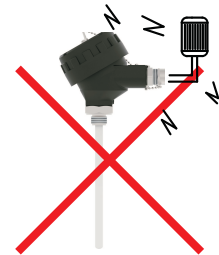

Excess current , to be drawn as
a result of direct connection to motor,
may burn relay of switch



Do not remove the plastic parts
of the bottom of the switch body ,
do not loosen.



Do not connect the switch in reverse.
Their characteristics may vary.

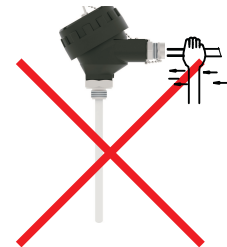

Do not pull the cable strongly,
otherwise the characteristics
might be changed.

3. Failure Delection



Your device must be repair only at an authorized serviced.

Breakdown	Probable cause	Failure detection\correction
Power Led does not work.	* Supply voltage may not be work. * Power led might be faulty. * Electronic card might be faulty due to supply.	* The supply voltage must be checked. * Please apply to service. * Please apply to service.
Relay does not output	* The applied process may not be suitable for the probe * Grounding connection might be poor or disconnected * The low voltage might be supply. * Grounding might be done correctly.	* Proper probe structure and product detection must be performed. * The grounding connection check. * Supply must be checked. * Please check grounding line.
Relay provides continuous output.	* The applied process may not be suitable for the probe. * The Teflon coating on the product probe might be damaged. * Grounding might be done correctly.	* Proper probe structure and product detection must be performed. * Protection of external coatings of probes. * Please check grounding line.
Non-Calibration	* Trimpot might be deformed. * The applied process may not be suitable for the probe. * Grounding might be done correctly.	* Please apply to service. * Proper probe structure and product detection must be performed. * Please check grounding line.

If you find an error, try to eliminate it by using this table or send the instrument to our service address for repair.



The instrument should be repaired only by authorized service! Serial number shall be indicated to the authorized service center.

4. Disassembly of Instrument

Instrument should be disassembled while feeding and pressure is not available!

5. Service

The instrument does not require maintenance. If it is desired, residue accumulated inside should be blown according to kind of fluid and instrument can be cleaned with soft cleaning solutions. Measures should be taken during the disassembly.

6. Re-Calibration

During long period usage of capacitive level switch, there might be deviations on measurements. In those cases, recalibration is recommended. Re-calibration could be made by your technical staff or you could send to manufacturer company. According to IEC 60017, ex proof devices must be go through detailed inspection every 3 yearS from purchase date.Responsibility of inspections are belong to the user (IEC: International Electrotechnical Commission)

7. Repair – Manufacturer Address

If irreparable breakdowns occur, the instrument should be sent to us for repair purpose. Before this, the instrument should be cleaned carefully and packaged so as not to be broken. Furthermore, you should also add a detailed explanation which describes the breakdown while instrument is sent. If your instrument contacts with harmful substances, decontamination report should be also sent additionally. In the event that instrument does not have any decontamination report or our service department has doubts about instrument, repair process will not start until an acceptable report is sent.

If the instrument contacts with hazardous substances, necessary measures should be taken for decontamination!

Service -Manufacturer Company Name and Address:



LONCA MAK. SAN. TİC. A.Ş. Ferhatpaşa Mah. Gazipaşa Cad. No: 104A Ataşehir - İSTANBUL - TÜRKİYE
Tel:+90 216 50 50 555 Faks:+90 216 515 45 84 E-Mail: lonca@ensim.com.tr Web: www.ensim.com.tr

8. Disposal

The instrument should be disposed according to 2002/96/EC and 2003/108/EC European Directives (waste electrical and electronic instruments). Waste electrical and electronic equipment should not be mixed with domestic wastes!



If the instrument has contacted with harmful substances, special attention should be paid for its disposal!

9. Terms of Warranty

The instrument has warranty legally for 24 months after delivery date. Warranty demands are not accepted in case of inappropriate operation, damage on the instrument or any modification on the instrument.

10. Terms of Return

In the return of materials, user should send an open list related to damage or problem, malfunction of the material to be returned or its operation in the different modification, with the instrument. If it is required to return the material, used in the dangerous, corrosive or toxic fluid, in this case, used part should be cleaned very carefully. Security of personnel should be ensured. All products to be returned should be sent to our company address, which we have stated.